

TOROIDAL CORE(T)

Ordering code

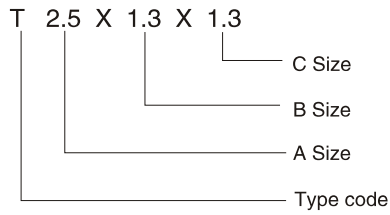

CONFIGURATIONS(mm)

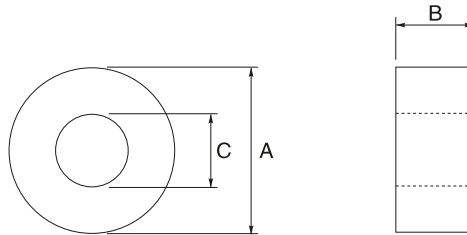

DIMENSION OF MAIN PRODUCTIONS & IMPEDANCE@25°C

Part No.	A	B	C	IMPEDANCE	
				25MHz(Ω)	100MHz(Ω)
T2.5X1.3X1.3	2.5±0.3	1.3±0.3	1.3±0.3	10	50
T3X3X1.2	3.0±0.3	3.0±0.3	1.2±0.3	20	65
T3.5X2X1.8	3.5±0.4	2.0±0.4	1.8±0.3	20	60
T3.5X3X1.0	3.5±0.4	3.0±0.4	1.0±0.3	30	75
T3.5X3X0.8	3.5±0.4	3.0±0.4	0.8±0.3	30	80
T3.5X3X1.8	3.5±0.4	3.0±0.4	1.8±0.3	20	65
T3.5X3.2X1.6	3.5±0.4	3.2±0.4	1.6±0.3	20	65
T4X1X2	4.0±0.4	1.0±0.3	2.0±0.3	15	60
T4X2X2	4.0±0.4	2.0±0.4	2.0±0.3	20	65
T4X3X2	4.0±0.4	3.0±0.4	2.0±0.3	20	65
T4X4X1.5	4.0±0.4	4.0±0.4	1.5±0.3	25	70
T4X4X2	4.0±0.4	4.0±0.4	2.0±0.3	20	70
T5X2.5X3	5.0±0.4	2.5±0.4	3.0±0.3	15	65
T5X4X3	5.0±0.4	4.0±0.4	3.0±0.3	20	65
T5X5X3	5.0±0.4	5.0±0.4	3.0±0.3	25	70
T6X2X3	6.0±0.4	2.0±0.3	3.0±0.3	15	60
T6X3X3	6.0±0.4	3.0±0.4	3.0±0.3	20	65
T6X3X4	6.0±0.4	3.0±0.4	4.0±0.4	15	60
T6X4X3	6.0±0.4	4.0±0.4	3.0±0.3	25	70
T6X4X4	6.0±0.4	4.0±0.4	4.0±0.4	20	65
T6X6X3	6.0±0.4	6.0±0.4	3.0±0.3	25	75
T6X6X4	6.0±0.4	6.0±0.4	4.0±0.4	20	65
T6.5X5X4	6.5±0.4	5.0±0.4	4.0±0.4	20	70
T6.5X5X4.3	6.5±0.4	5.0±0.4	4.3±0.4	20	65
T7X7X4	7.0±0.4	7.0±0.4	4.0±0.4	25	80

TOROIDAL CORE(T)**DIMENSION OF MAIN PRODUCTIONS & IMPEDANCE@25°C**

Part No.	A	B	C	IMPEDANCE	
				25MHz(Ω)	100MHz(Ω)
T7.6X2X5.3	7.6±0.4	2.0±0.4	5.3±0.4	15	60
T7.6X3.6X4.2	7.6±0.4	3.6±0.4	4.2±0.4	20	70
T7.6X5X5.2	7.6±0.4	5.0±0.4	5.2±0.4	20	65
T7.6X6X5	7.6±0.4	6.0±0.4	5.0±0.4	20	70
T8X2X4	8.0±0.3	2.0±0.4	4.0±0.4	15	60
T8X3X4	8.0±0.4	3.0±0.4	4.0±0.4	20	65
T8X4X4	8.0±0.4	4.0±0.4	4.0±0.4	25	70
T8X6.3X5.6	8.0±0.4	6.3±0.4	5.6±0.4	20	70
T8X7X6	8.0±0.4	7.0±0.4	6.0±0.4	20	65
T8X7.5X5.3	8.0±0.4	7.5±0.4	5.3±0.4	20	75
T8X8X4	8.0±0.4	8.0±0.4	4.0±0.4	35	90
T9X3X5	9.0±0.4	3.0±0.4	5.0±0.4	20	60
T9.1X4.6X5	9.1±0.4	4.6±0.4	5.0±0.4	20	70
T9X4.5X5	9.0±0.4	4.5±0.4	5.0±0.4	20	70
T9X8X5	9.0±0.3	8.0±0.3	5.0±0.3	30	80
T9.5X5X5	9.5±0.4	5.0±0.4	5.0±0.4	20	70
T9.5X9.5X5	9.5±0.4	9.5±0.4	5.0±0.4	35	90
T9.8X6.5X6	9.8±0.4	6.5±0.4	6.0±0.4	25	75
T10X2X6	10.0±0.4	2.0±0.4	6.0±0.4	15	60
T10X3X6	10.0±0.4	3.0±0.4	6.0±0.4	20	60
T10X4X6	10.0±0.4	4.0±0.4	6.0±0.4	20	65
T10X4X7	10.0±0.4	4.0±0.4	7.0±0.4	20	60
T10X5X5	10.0±0.4	5.0±0.4	5.0±0.4	25	75
T10X5X6	10.0±0.4	5.0±0.4	6.0±0.4	20	70
T10X6X6	10.0±0.5	6.0±0.5	6.0±0.5	25	75
T10X5X7	10.0±0.5	6.0±0.5	7.0±0.5	20	65
T10X7X6	10.0±0.4	7.0±0.4	6.0±0.4	25	75
T10X7.5X6	10.0±0.4	7.5±0.4	6.0±0.4	25	80
T10X7X7	10.0±0.4	7.0±0.4	7.0±0.4	20	70
T10X7.5X7	10.0±0.4	7.5±0.4	7.0±0.4	25	70
T10X8X6	10.0±0.4	8.0±0.4	6.0±0.4	30	80
T10X10X4.2	10.0±0.4	10.0±0.4	4.2±0.4	55	115
T10X10X5	10.0±0.4	10.0±0.4	5.0±0.4	35	85
T10X10X6	10.0±0.4	10.0±0.4	6.0±0.4	35	85
T10X10X7	10.0±0.5	10.0±0.4	7.0±0.4	30	80
T10.5X10X7.3	10.5±0.4	10.0±0.4	7.3±0.4	25	75
T10X20X4.2	10.0±0.4	20.0±0.6	4.2±0.6	100	200
T11X8X5	11.0±0.5	8.0±0.4	5.0±0.4	30	90
T12X4X6	12.0±0.5	4.0±0.4	6.0±0.4	25	70
T12X5X8	12.0±0.5	5.0±0.4	8.0±0.4	20	65
T12X5.3X7.3	12.0±0.5	5.3±0.4	7.3±0.4	20	75

TOROIDAL CORE(T)**DIMENSION OF MAIN PRODUCTIONS & IMPEDANCE@25°C**

Part No.	A	B	C	IMPEDANCE	
				25MHz(Ω)	100MHz(Ω)
T12X5.5X7	12.0±0.5	5.5±0.4	7.0±0.4	20	70
T12X6X6	12.0±0.5	6.0±0.4	6.0±0.4	25	80
T12X6X7.3	12.0±0.5	6.0±0.4	7.3±0.4	25	70
T12X7X8	12.0±0.5	7.0±0.4	8.0±0.4	20	70
T12X8X6	12.0±0.5	8.0±0.4	6.0±0.4	35	85
T12X8X7	12.0±0.5	8.0±0.4	7.0±0.4	30	85
T12X9X5.6	12.0±0.5	9.0±0.4	5.6±0.4	40	105
T12X10X3.55	12.0±0.5	10.0±0.4	3.55±0.4	85	180
T12X10X7	12.0±0.5	10.0±0.4	7.0±0.4	35	85
T12X12X5.6	12.0±0.5	12.0±0.5	5.6±0.4	45	110
T12X12X6.5	12.0±0.5	12.0±0.5	6.5±0.4	40	95
T12X12X8	12.0±0.5	12.0±0.5	8.0±0.4	35	90
T12.5X6.5X5	12.5±0.5	6.5±0.4	5.0±0.4	35	85
T12.5X12X8	12.5±0.5	12.0±0.5	8.0±0.4	35	90
T12.7X6.35X7.9	12.7±0.5	6.35±0.3	7.9±0.4	25	70
T12.7X4.8X7.9	12.7±0.5	4.8±0.4	7.9±0.4	20	70
T12.7X9.6X7.9	12.7±0.5	9.6±0.4	7.9±0.4	30	90
T12.7X12.7X7.3	12.7±0.5	12.7±0.5	7.3±0.4	45	100
T12.7X12.7X7.9	12.7±0.5	12.7±0.5	7.9±0.4	40	95
T12.7X12.7X11	12.7±0.5	12.7±0.5	11.0±0.4	20	70
T13X3X7	13.0±0.5	3.0±0.4	7.0±0.4	20	65
T13X6.3X7	13.0±0.5	6.3±0.4	7.0±0.4	25	75
T13X6.5X8	13.0±0.5	6.3±0.4	8.0±0.4	20	70
T13X7X7	13.0±0.5	7.0±0.4	7.0±0.4	30	80
T13X10X8.2	13.0±0.5	10.0±0.4	8.2±0.5	30	85
T13X12.7X7.1	13.0±0.5	12.7±0.5	7.1±0.5	40	100
T14X4X8	14.0±0.5	4.0±0.4	8.0±0.4	20	70
T14X5X8	14.0±0.5	5.0±0.4	8.0±0.4	20	70
T14X5X9	14.0±0.5	5.0±0.4	9.0±0.4	20	70
T14X5.5X9	14.0±0.5	5.5±0.4	9.0±0.4	20	70
T14X14X10	14.0±0.5	14.0±0.5	10.0±0.4	35	90
T14.2X5X10	14.2±0.5	5.0±0.4	10.0±0.4	20	65
T14.2X5.5X8.7	14.2±0.5	5.5±0.4	8.7±0.4	20	70
T14.2X7X8	14.2±0.5	7.0±0.4	8.0±0.4	25	80
T14.2X8X9	14.2±0.5	8.0±0.4	9.0±0.4	25	75
T14.2X10X8	14.2±0.5	10.0±0.4	8.0±0.4	35	95
T14.2X8X10	14.2±0.5	8.0±0.6	10.0±0.6	20	70
T14.2X10.16X6.35	14.2±0.5	10.16±0.4	6.35±0.4	40	100
T14.2X12X7.8	14.2±0.5	12.0±0.4	7.8±0.4	45	105
T14.2X12.7X6.7	14.2±0.5	12.7±0.5	6.7±0.4	50	110
T14.2X13X8	14.2±0.5	13.0±0.5	8.0±0.4	45	110

TOROIDAL CORE(T)

DIMENSION OF MAIN PRODUCTIONS & IMPEDANCE@25°C

Part No.	A	B	C	IMPEDANCE	
				25MHz(Ω)	100MHz(Ω)
T14.2X13.8X6.35	14.2±0.5	13.8±0.5	6.35±0.4	50	130
T14.5X8X10	14.5±0.5	8.0±0.4	10.0±0.5	25	70
T15X5X10	15.0±0.5	5.0±0.4	10.0±0.5	20	65
T15X15X10.5	15.0±0.5	15.0±0.4	10.5±0.5	30	90
T15.2X12.5X10.5	15.2±0.5	12.5±0.4	10.5±0.5	30	85
T15.6X14X13.4	15.6±0.5	14.0±0.4	13.4±0.5	25	75
T15.87X14.3X7.9	15.87±0.5	14.3±0.4	7.9±0.4	55	125
T16X4X9	16.0±0.5	4.0±0.4	9.0±0.5	20	70
T16X4X10	16.0±0.5	4.0±0.4	10.0±0.5	20	65
T16X5X10	16.0±0.5	5.0±0.5	10.0±0.5	20	70
T16X5.4X9	16.0±0.5	5.4±0.5	9.0±0.5	20	70
T16X7X9	16.0±0.5	7.0±0.5	9.0±0.5	30	80
T16X7X10	16.0±0.5	7.0±0.4	10.0±0.5	25	75
T16X8X10	16.0±0.5	8.0±0.4	10.0±0.5	25	80
T16X8X12	16.0±0.5	8.0±0.4	12.0±0.5	20	70
T16X10X7	16.0±0.5	10.0±0.4	7.0±0.4	40	105
T16X10X8	16.0±0.5	10.0±0.4	8.0±0.4	45	105
T16X10X9	16.0±0.5	10.0±0.4	9.0±0.5	40	95
T16X10X10	16.0±0.5	10.0±0.4	10.0±0.5	30	85
T16X10X12	16.0±0.5	10.0±0.4	12.0±0.5	25	75
T16X12X9.5	16.0±0.5	12.0±0.5	9.5±0.5	30	90
T16X12X10	16.0±0.5	12.0±0.5	10.0±0.5	30	90
T16X13X8	16.0±0.5	13.0±0.5	8.0±0.4	45	115
T16X13X9	16.0±0.5	13.0±0.5	9.0±0.5	40	100
T16X14X10	16.0±0.5	14.0±0.5	10.0±0.5	40	100
T16X15X9	16.0±0.5	15.0±0.5	9.0±0.5	50	115
T16X16X8	16.0±0.5	16.0±0.5	8.0±0.4	65	130
T16X16X9	16.0±0.5	16.0±0.5	9.0±0.5	50	115
T16X16X10	16.0±0.5	16.0±0.5	10.0±0.5	50	110
T17.5X6.35X9.5	17.5±0.6	6.35±0.4	9.5±0.5	25	75
T17.5X7X9.6	17.5±0.6	7.0±0.4	9.6±0.5	30	85
T17.5X10X8	17.5±0.6	10.0±0.4	8.0±0.4	40	100
T17.5X11X9.5	17.5±0.6	11.0±0.5	9.5±0.5	40	90
T17.5X12X11.3	17.5±0.6	12.0±0.5	11.3±0.5	30	90
T17.5X12.5X12	17.5±0.6	12.5±0.5	12.0±0.5	30	90
T17.5X9.5X12.7	17.5±0.6	9.5±0.4	12.7±0.5	25	80
T17.5X12.7X9.5	17.5±0.6	12.7±0.5	9.5±0.5	45	110
T17.5X12.7X10.7	17.5±0.6	12.7±0.5	10.7±0.5	40	95
T17.5X13.5X9.5	17.5±0.6	13.5±0.5	9.5±0.5	50	110
T17.5X15X9.5	17.5±0.6	15.0±0.5	9.5±0.5	55	125
T18X6X10	18.0±0.6	6.0±0.5	10.0±0.5	25	75

TOROIDAL CORE(T)**DIMENSION OF MAIN PRODUCTIONS & IMPEDANCE@25°C**

Part No.	A	B	C	IMPEDANCE	
				25MHz(Ω)	100MHz(Ω)
T18X7X10	18.0±0.6	7.0±0.4	10.0±0.4	30	80
T18X8X10	18.0±0.6	8.0±0.4	10.0±0.5	30	85
T18X10X10	18.0±0.6	10.0±0.4	10.0±0.5	35	90
T18X12X10	18.0±0.6	12.0±0.5	10.0±0.5	45	105
T18X12X12	18.0±0.6	12.0±0.5	12.0±0.5	30	85
T18X14X10	18.0±0.6	14.0±0.5	10.0±0.5	50	110
T18X15X10	18.0±0.6	15.0±0.5	10.0±0.4	50	120
T18X18X10	18.0±0.6	18.0±0.6	10.0±0.5	70	130
T18.2X6.4X11.2	18.2±0.6	6.4±0.4	11.2±0.5	20	75
T18.2X6.5X10	18.2±0.6	6.5±0.4	10.0±0.5	25	80
T18.4X9.6X12.5	18.4±0.6	9.6±0.4	12.5±0.5	25	85
T18.2X12.5X9.5	18.2±0.6	12.5±0.5	9.5±0.5	50	110
T18.4X14.3X9.5	18.4±0.6	14.3±0.5	9.5±0.5	50	115
T19X11X13	19.0±0.6	11.0±0.5	13.0±0.5	30	80
T19.5X12.7X9.5	19.5±0.6	12.7±0.5	9.5±0.5	50	120
T20X5X10	20.0±0.6	5.0±0.4	10.0±0.5	25	75
T20X7X10	20.0±0.6	7.0±0.4	10.0±0.5	30	80
T20X8X10	20.0±0.6	8.0±0.4	10.0±0.5	35	90
T20X10X10	20.0±0.6	10.0±0.4	10.0±0.5	40	95
T20X15X10	20.0±0.6	15.0±0.5	10.0±0.5	65	135
T20.8X30X11.6	20.8±0.6	30.0±0.5	11.6±0.5	90	200
T21X13X12	21.0±0.6	13.0±0.5	12.0±0.5	35	95
T21X12X13.2	21.0±0.6	12.0±0.5	13.2±0.5	30	85
T21X6X12.7	21.0±0.6	6.0±0.4	12.7±0.5	20	75
T22X8X14	22.0±0.6	8.0±0.4	14.0±0.5	30	80
T22.5X6.4X13.8	22.5±0.6	6.4±0.4	13.8±0.5	25	75
T22.5X6.4X14.3	22.5±0.6	6.4±0.4	14.3±0.4	25	70
T22.5X8X13.8	22.5±0.6	8.0±0.4	13.8±0.5	30	80
T22.5X10X13.8	22.5±0.6	10.0±0.4	13.8±0.5	35	90
T22.5X9.5X13.5	22.5±0.6	9.5±0.4	13.5±0.5	30	85
T22.5X12.7X13.5	22.5±0.6	12.7±0.5	13.5±0.5	40	95
T23X10X18	23.0±0.6	10.0±0.4	18.0±0.5	20	70
T23.5X9.5X12.7	23.5±0.6	9.5±0.4	12.7±0.5	35	90
T24X14X11.4	24.0±0.6	14.0±0.5	11.4±0.5	50	120
T25X8X15	25.0±0.6	8.0±0.4	15.0±0.5	25	80
T25X10X15	25.0±0.6	10.0±0.4	15.0±0.5	30	85
T25X12X15	25.0±0.6	12.0±0.5	15.0±0.5	40	95
T25X15X13	25.0±0.6	15.0±0.5	13.0±0.5	55	125
T25X15X15	25.0±0.6	15.0±0.5	15.0±0.5	45	110
T26X8X16	26.0±0.6	8.0±0.4	16.0±0.5	25	80
T26X15X13	26.0±0.6	15.0±0.5	13.0±0.5	50	120

TOROIDAL CORE(T)**DIMENSION OF MAIN PRODUCTIONS & IMPEDANCE@25°C**

Part No.	A	B	C	IMPEDANCE	
				25MHz(Ω)	100MHz(Ω)
T28X7.5X16	28.0±0.7	7.5±0.4	16.0±0.6	30	80
T28X8X18	28.0±0.7	8.0±0.4	18.0±0.6	25	80
T28X10X16	28.0±0.7	10.0±0.4	16.0±0.6	35	90
T28X10X18	28.0±0.7	10.0±0.4	18.0±0.6	30	85
T28X13X16	28.0±0.7	13.0±0.5	16.0±0.6	45	105
T28X20X16	28.0±0.7	20.0±0.5	16.0±0.6	50	135
T28.5X28.5X13.8	28.5±0.7	28.5±0.7	13.8±0.5	120	250
T28X28X16	28.0±0.7	28.0±0.7	16.0±0.6	85	200
T29X7.7X19	29.0±1	7.7±0.4	19.0±0.6	25	75
T29X10X19	29.0±1	10.0±0.4	19.0±0.6	30	90
T29X12X19	29.0±1	12.0±0.4	19.0±0.6	35	90
T29X13.8X19	29.0±1	13.8±0.5	19.0±0.6	45	95
T29X15X19	29.0±1	15.0±0.5	19.0±0.6	35	100
T31X5X19	31.0±1	5.0±0.4	19.0±0.6	20	70
T31X7X19	31.0±1	7.0±0.4	19.0±0.6	25	80
T31X8X19	31.0±1	8.0±0.4	19.0±0.6	25	80
T31X10X19	31.0±1	10.0±0.4	19.0±0.6	35	90
T31X12X18	31.0±1	12.0±0.5	18.0±0.6	35	105
T31X12X21	31.0±1	12.0±0.5	21.0±0.5	30	85
T31X13X19	31.0±1	13.0±0.5	19.0±0.6	40	100
T31X16X19	31.0±1	16.0±0.5	19.0±0.6	50	115
T31X18X19	31.0±1	18.0±0.5	19.0±0.6	50	125
T35X6X20.8	35.0±1	6.0±0.5	20.8±0.6	30	75
T35X12.6X20.8	35.0±1	12.6±0.5	20.8±0.6	50	100
T36X10X20	36.0±1	10.0±0.4	20.0±0.6	30	70
T36X12X25	36.0±1	12.0±0.5	25.0±0.6	30	90
T36X12.7X25	36.0±1	12.7±0.5	25.0±0.6	35	85
T36X13X23	36.0±1	13.0±0.5	23.0±0.6	35	95
T36X20X23	36.0±1	20.0±0.6	23.0±0.6	50	115
T36X23X15	36.0±1	23.0±0.6	15.0±0.6	100	210
T40.6X15X27.4	40.6±1.5	15.0±0.5	27.4±0.6	40	90

Remarks: Other sizes are available upon request if your needs not listed in the catalog